

NOTICE!!

These documents have been scanned!

Do not place un-scanned documents beneath this notice!

Do not remove this notice from this file!

GPO Jacket No. 560-102
Print Order 61540
Rise Business Services, LLC
Job=AZ15 5/13/2019



Box Number= AZ15040



Claim Begin-End: AMC423065-AMC423066

1 Initial Receipt



AZ15040-15

AMC422569-AMC423150

**United States Department of the Interior
Bureau of Land Management
BUSINESS & SUPPORT SVCS DIV
ONE N CENTRAL AVE SUITE 800
PHOENIX, AZ 85004 -4427
Phone: (602) 417-9200**

Receipt

No: 3363630

Transaction #: 3461665	
Date of Transaction: 08/10/2015	
CUSTOMER:	
GREGORY A WEST 327 E WASHINGTON AVE HOBART,IN 46342 US	

LINE #	QTY	DESCRIPTION	REMARKS	UNIT PRICE	TOTAL
1	1.00	LOCATABLE MINERALS / MINING CLAIMS- NOT NEW-UNADJUD,ONE AUTH NO. ONLY / MINING CLAIM MONEY RECEIVED CASES: AMC423066/\$465.00		- n/a -	465.00
TOTAL:					\$465.00

PAYMENT INFORMATION			
NOTE: Items will appear on credit card statement as "BLM O Mining Claim".			
1	AMOUNT:	465.00	POSTMARKED: N/A
	TYPE:	CREDIT CARD	RECEIVED: 08/10/2015
	NAME:	GREGORY A WEST 327 E WASHINGTON AVE HOBART IN 46342 US	
	CARD NO:	XXXXXXXXXXXX2821	AUTH CODE: 010860
	NAME ON CARD:	GREGORY A WEST	
	EXPIRES:	01/2018	
	SIGNATURE:		

REMARKS

This receipt was generated by the automated BLM Collections and Billing System and is a paper representation of a portion of the official electronic record contained therein.

Run Date: 08/12/15

Run Time: 08:37 AM

**DEPARTMENT OF THE INTERIOR
BUREAU OF LAND MANAGEMENT
MINING CLAIMS**

MC Maintenance Fees Paid Through the BLM Pay Portal

CBS Receipt: 3363630

Printed For Lead File # AMC426231

Agency Tracking ID: 1439242057

Assessment Year: 2016

Number of BLM Serial Nr: 3

Paid On: 08/10/2015

Total Amount Paid: \$465.00

Claim Name	BLM Serial No	Lead File No	Amount Paid
BONNIE	AMC423066	AMC423065	\$155.00
BLACK NUGGET	AMC423705	AMC423705	\$155.00
COYOTE WASH GOLD #1	AMC426235	AMC426231	\$155.00

**United States Department of the Interior
Bureau of Land Management
BUSINESS & SUPPORT SVCS DIV
ONE N CENTRAL AVE SUITE 800
PHOENIX, AZ 85004 -4427
Phone: (602) 417-9200**

Receipt

No: 3363630

Transaction #: 3461665	
Date of Transaction: 08/10/2015	
CUSTOMER:	
GREGORY A WEST 327 E WASHINGTON AVE HOBART,IN 46342 US	

LINE #	QTY	DESCRIPTION	REMARKS	UNIT PRICE	TOTAL
1	1.00	LOCATABLE MINERALS / MINING CLAIMS- NOT NEW-UNADJUD,ONE AUTH NO. ONLY / MINING CLAIM MONEY RECEIVED CASES: AMC423066/\$465.00		- n/a -	465.00
TOTAL:					\$465.00

PAYMENT INFORMATION			
NOTE: Items will appear on credit card statement as "BLM O Mining Claim".			
1	AMOUNT:	465.00	POSTMARKED: N/A
	TYPE:	CREDIT CARD	RECEIVED: 08/10/2015
	NAME:	GREGORY A WEST 327 E WASHINGTON AVE HOBART IN 46342 US	
	CARD NO:	XXXXXXXXXXXX2821	AUTH CODE: 010860
	NAME ON CARD:	GREGORY A WEST	
	EXPIRES:	01/2018	
	SIGNATURE:		

REMARKS

This receipt was generated by the automated BLM Collections and Billing System and is a paper representation of a portion of the official electronic record contained therein.

Run Date: 08/12/15

Run Time: 08:37 AM

**DEPARTMENT OF THE INTERIOR
BUREAU OF LAND MANAGEMENT
MINING CLAIMS**

MC Maintenance Fees Paid Through the BLM Pay Portal

CBS Receipt: 3363630

Printed For Lead File # AMC423065

Agency Tracking ID: 1439242057

Assessment Year: 2016

Number of BLM Serial Nr: 3

Paid On: 08/10/2015

Total Amount Paid: \$465.00

Claim Name	BLM Serial No	Lead File No	Amount Paid
BONNIE	AMC423066	AMC423065	\$155.00
BLACK NUGGET	AMC423705	AMC423705	\$155.00
COYOTE WASH GOLD #1	AMC426235	AMC426231	\$155.00

**United States Department of the Interior
Bureau of Land Management
BUSINESS & SUPPORT SVCS DIV
ONE N CENTRAL AVE SUITE 800
PHOENIX, AZ 85004 -4427
Phone: (602) 417-9200**

Receipt

No: 3363630

Transaction #: 3461665	
Date of Transaction: 08/10/2015	
CUSTOMER:	
GREGORY A WEST 327 E WASHINGTON AVE HOBART,IN 46342 US	

LINE #	QTY	DESCRIPTION	REMARKS	UNIT PRICE	TOTAL
1	1.00	LOCATABLE MINERALS / MINING CLAIMS- NOT NEW-UNADJUD,ONE AUTH NO. ONLY / MINING CLAIM MONEY RECEIVED CASES: AMC423066/\$465.00		- n/a -	465.00
TOTAL:					\$465.00

PAYMENT INFORMATION			
NOTE: Items will appear on credit card statement as "BLM O Mining Claim".			
1	AMOUNT:	465.00	POSTMARKED: N/A
	TYPE:	CREDIT CARD	RECEIVED: 08/10/2015
	NAME:	GREGORY A WEST 327 E WASHINGTON AVE HOBART IN 46342 US	
	CARD NO:	XXXXXXXXXXXX2821	AUTH CODE: 010860
	NAME ON CARD:	GREGORY A WEST	
	EXPIRES:	01/2018	
	SIGNATURE:		

REMARKS

This receipt was generated by the automated BLM Collections and Billing System and is a paper representation of a portion of the official electronic record contained therein.

Run Date: 08/12/15

Run Time: 08:37 AM

**DEPARTMENT OF THE INTERIOR
BUREAU OF LAND MANAGEMENT
MINING CLAIMS**

MC Maintenance Fees Paid Through the BLM Pay Portal

CBS Receipt: 3363630

Printed For Lead File # AMC423705

Agency Tracking ID: 1439242057

Assessment Year: 2016

Number of BLM Serial Nr: 3

Paid On: 08/10/2015

Total Amount Paid: \$465.00

Claim Name	BLM Serial No	Lead File No	Amount Paid
BONNIE	AMC423066	AMC423065	\$155.00
BLACK NUGGET	AMC423705	AMC423705	\$155.00
COYOTE WASH GOLD #1	AMC426235	AMC426231	\$155.00

United States Department of the Interior
Bureau of Land Management
 LANDS/RECREATION & PLANNING
 ONE N CENTRAL AVE
 PHOENIX, AZ 85004 -2203
 Phone: 602-417-9200

Receipt

No: 2787309

Transaction #: 2871926	ENTERED INTO COMPUTER
Date of Transaction: 05/06/2013	
CUSTOMER: JUN 14 2013 <i>LB</i>	
DEPARTMENT OF LAND TRANSFER INFORMATION 942 CALLE AMANECER STE B SAN CLEMENTE, CA 92673-6220 US	

LINE #	QTY	DESCRIPTION	REMARKS	UNIT PRICE	TOTAL
1	2.00	LOCATABLE MINERALS / MINING CLAIMS- NEW, UNADJUD, ONE OR MORE AUTH NOS / NEW MINING CLAIM LOCATION FEE \$34 CASES: AMC423065/\$34.00, AMC423066/\$34.00		- n/a -	68.00
2	2.00	LOCATABLE MINERALS / MINING CLAIMS- NEW, UNADJUD, ONE OR MORE AUTH NOS / NEW MINING CLAIM PROCESSING FEE \$15 CASES: AMC423065/\$15.00, AMC423066/\$15.00		- n/a -	30.00
3	2.00	LOCATABLE MINERALS / MINING CLAIMS- NEW, UNADJUD, ONE OR MORE AUTH NOS / NEW MINING CLAIM MAINT FEE \$140 CASES: AMC423065/\$140.00, AMC423066/\$140.00		- n/a -	280.00
TOTAL:					\$378.00

PAYMENT INFORMATION			
1	AMOUNT:	378.00	POSTMARKED: 05/02/2013
	TYPE:	CHECK	RECEIVED: 05/02/2013
	CHECK NO:	4813	
	NAME:	DEPARTMENT OF LAND TRANSFER INFORMATION 942 CALLE AMANECER STE B SAN CLEMENTE CA 92673-6220 US	

REMARKS

This receipt was generated by the automated BLM Collections and Billing System and is a paper representation of a portion of the official electronic record contained therein.

NOTICE!!

These documents have been scanned!

Do not place un-scanned documents beneath this notice!

Do not remove this notice from this file!

GPO Jacket No. 560-102
Print Order 61540
Rise Business Services, LLC
Job=AZ15 5/13/2019



Box Number= AZ15040



Claim Begin-End: AMC423065-AMC423066

2 Correspondence



AZ15040-15

AMC422569-AMC423150



United States Department of the Interior



BUREAU OF LAND MANAGEMENT
Arizona State Office
One North Central Avenue, Suite 800
Phoenix, Arizona 85004-4427
www.blm.gov/az/

February 20, 2014

In Reply Refer To:
3800 (9310) PB
AMC423065

CERTIFIED MAIL - RETURN RECEIPT REQUESTED No. 7013 2250 0000 8721 7568

DECISION

DEPT. OF LAND TRANSFER INFO., INC. :
942 CALLE AMANECER STE. B : This decision affects those claims shown
SAN CLEMENTE, CA 92673-6220 : in the block below.

AMC423065
BIG STING

MINING CLAIMS DECLARED FORFEIT

The mining claims listed above have been declared forfeit as of September 1, 2013, for failure to timely file the required maintenance fee payment or small miner's maintenance fee waiver (waiver).

Claimants are required to pay an annual non-refundable maintenance fee of \$140 per 20 acres, or submit a waiver, on or before September 1 of each year. (In accordance with 43 CFR 1822.14, because September 1, 2013, fell on a Sunday and Monday was a holiday, the payment was due the next business day, September 3, 2013.) These requirements were established by 30 U.S.C. 28f-1, as amended, and 43 Code of Federal Regulations (CFR) 3834 and 3835.

Our records do not show receipt of a maintenance fee payment or small miner waiver filed on or before the due date. Therefore, the claims listed above are forfeit.

This decision does not relieve you of the liability for reclamation of all areas disturbed by your activities on lands covered by the subject mining claim(s) and/or site(s). After you complete the reclamation, you must notify the authorized officer of the appropriate surface managing agency so that the authorized officer may conduct a final site inspection and determine whether you may be released from liability. If you fail to reclaim the land to the satisfaction of the authorized officer, the surface management agency may cite you for noncompliance under its surface management regulations.

SENDER: COMPLETE THIS SECTION

- Complete items 1, 2, and 3. Also complete item 4 if Restricted Delivery is desired.
- Print your name and address on the reverse so that we can return the card to you.
- Attach this card to the back of the mailpiece, or on the front if space permits.

1. Article Addressed to:

DEPT. OF LAND TRANSFER INFO., INC.
 942 CALLE AMANECER STE. B
 SAN CLEMENTE, CA 92673-6220
 9310/PB/AMC423065

2. Article Number

(Transfer from service label)

COMPLETE THIS SECTION ON DELIVERY

A. Signature

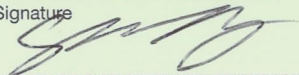
X Agent Addressee

B. Received by (Printed Name)

RECEIVED
 BLM AZ STATE OFFICE

C. Date of Delivery

2-27

D. Is delivery address different from item 1? YesIf YES, enter delivery address below: No

2014 MAR -4 A 3:11

PHOENIX, ARIZONA

3. Service Type

 Certified Mail Express Mail Registered Return Receipt for Merchandise Insured Mail C.O.D.

4. Restricted Delivery? (Extra Fee)

 Yes

7013 2250 0000 8721 7568

For land administered by the Bureau of Land Management (BLM), if you fail to reclaim the land to the satisfaction of the authorized officer as required in 43 CFR Subpart 3809, BLM will issue an order of noncompliance under 43 CFR 3809.601(a). If you fail to comply with the non-compliance order, BLM may take further action under 43 CFR 3809.604. Failure to conduct reclamation is a prohibited act that may subject you to criminal penalties. See 43 CFR 3809.605(h) and 43 CFR 3809.700.

Appeal Procedures

This decision may be appealed to the Interior Board of Land Appeals, Office of the Secretary, in accordance with the regulations contained in 43 CFR, Part 4, and the enclosed Form 1842-1. If an appeal is taken, your notice of appeal must be filed in this office (at the above address) within 30 days from receipt of this decision. The appellant has the burden of showing that the decision appealed from is in error.

If you wish to file a petition pursuant to regulation 43 CFR 4.21 (58 FR 4939, January 19, 1993) for a stay of the effectiveness of this decision during the time that your appeal is being reviewed by the Board, the petition for a stay must accompany your notice of appeal. A petition for a stay is required to show sufficient justification based on the standards listed below. Copies of the notice of appeal and petition for a stay **must** also be submitted to each party named in this decision and to the Interior Board of Land Appeals and to the appropriate Office of the Solicitor (see 43 CFR 4.413) at the same time the original documents are filed with this office. If you request a stay, you have the burden of proof to demonstrate that a stay should be granted.

Standards for Obtaining a Stay

Except as otherwise provided by law or other pertinent regulation, a petition for a stay of a decision pending appeal shall show sufficient justification based on the following standards:

- (1) The relative harm to the parties if the stay is granted or denied,
- (2) The likelihood of the appellant's success on the merits,
- (3) The likelihood of immediate and irreparable harm if the stay is not granted, and
- (4) Whether the public interest favors granting the stay.

Please include your AMC serial number(s) on all correspondence. If additional information is required, please call Pauline Brown at 602-417-9360.

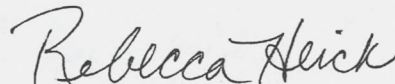

Rebecca Heick
Group Administrator
Lands and Minerals

Enclosure:
Appeal Form 1842-1

NOTICE!!

These documents have been scanned!

Do not place un-scanned documents beneath this notice!

Do not remove this notice from this file!

GPO Jacket No. 560-102
Print Order 61540
Rise Business Services, LLC
Job=AZ15 5/13/2019



Box Number= AZ15040



Claim Begin-End: AMC423065-AMC423066

3 Transfers



AZ15040-15

AMC422569-AMC423150

RECORDING REQUESTED BY:

(Mail recording to;)

Gregory West

327 E Washington Ave

Hobart, IN 46342-1164

AMC 423065

FOR RECORDER'S USE

UNPATENTED MINING CLAIM QUITCLAIM DEED

NOTICE IS HEREBY GIVEN that Department of Land Transfer Information, Inc., a Wyoming Corporation whose current mailing address is 942 Calle Amanecer, Suite B, San Clemente, CA 92673 (collectively, "GRANTOR"), in consideration of money received and other good and valuable consideration, do hereby remise, release and forever quitclaim to;

Gregory West, whose mailing address is 327 E Washington Ave., Hobart, IN 46342-1164 (collectively, "Grantee"), all rights, title and interest of Grantor, in and to the following mining claim; The **BONNIE** lode mining claim, **AMC423066**.

The general course of this claim is North and South and it is situated in the Gila Salt River Meridian, Mohave County, Arizona.

This claim is 1,500 feet in length and 600 feet in width. This claim runs from the location monument on which this location notice is posted approximately 1,200 feet in a Northerly direction to the North end line and approximately 300 feet in a Southerly direction to the South end line.

This claim is marked by four (4) monuments, one at each corner of the claim. Additionally, there are two (2) end-line markers on each side of the center of the claim. All markers are 4" x 4" wooden posts that are buried 1.5' in the ground and protrude 4.5' above the ground embossed with the name of the claim and its location in relation to the claim.

The location monument on which this notice is posted is situated within Section 12, Township 23N, Range 18W, Gila Salt River Meridian, Mohave County Arizona and this claim encompasses portions of the following quarter section (s), Township (s) and Range (s); SW 1/4 of SW 1/4 of Section 1, NW 1/4 of NW 1/4 of Section 12, T23N, R18W, Gila Salt River Meridian, Mohave County Arizona.

The locality of this claim with reference to some natural object or permanent monument and additional information (if any) concerning its locality are as follows: NW corner of this claim is 0 Feet East and 500 Feet North of the NW corner of Section 12, T23N, R18W, Gila Salt River Meridian, Mohave County AZ.

IN WITNESS WHEREOF, this Mining Claim Quitclaim Deed is executed on May 23, 2013:

DEPARTMENT OF LAND TRANSFER INFORMATION, INC.

Steven L. Cyros, President

Authorized Officer for DEPARTMENT OF LAND TRANSFER INFORMATION, INC.

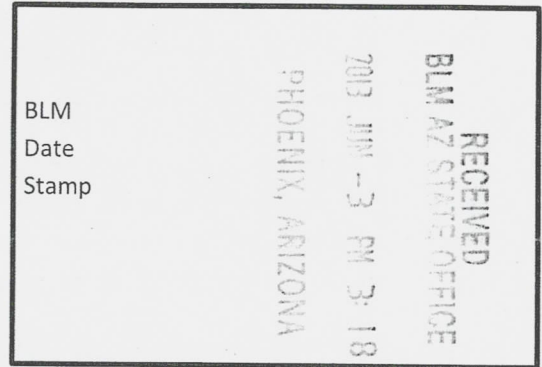

ENTERED IN COMPUTER
RE 7-30-13

Notary Certificate Attached

CALIFORNIA ALL-PURPOSE ACKNOWLEDGMENT

State of California
County of Orange } ss.

On May 23, 2013 before me, Brad Meindertsma, Notary Public,
Personally appeared Steven L. Cyros

who proved to me on the basis of satisfactory evidence to be the person ~~(s)~~ whose names ~~(s)~~ is/are subscribed to the within instrument and acknowledge to me that he/~~she/they~~ executed the same in his/~~her/their~~ authorized capacity~~(ies)~~, and that by his/~~her/their~~ signature~~(s)~~ on the instrument the person~~(s)~~, or entity upon behalf of which the person~~(s)~~ acted, executed the instrument.

I certify under the PENALTY OF PERJURY under the laws of the State of California that the foregoing paragraph is true and correct.

WITNESS my hand and official seal.

Signature

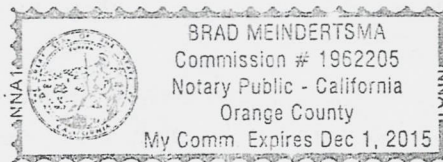

(seal)

OPTIONAL INFORMATION

Date of Document May 23, 2013
Type or Title of Document Quitclaim Deed
Number of Pages in Document 1
Document in a Foreign Language NA

Thumbprint of Signer



Capacity of Signer:

- Individual
- Corporate Officer – Title(s): President
- Partner - Limited General
- Attorney In Fact
- Trustee
- Guardian or Conservator
- Other: _____

Signer is Representing: Department of Land Transfer Information, Inc.

RECEIVED
BLM AZ STATE OFFICE
2013 JUN -3 PM 3:18
PHOENIX, ARIZONA

United States Department of the Interior
Bureau of Land Management
 LANDS/RECREATION & PLANNING
 ONE N CENTRAL AVE
 PHOENIX, AZ 85004 -2203
 Phone: 602-417-9200

Receipt

No: 2806586

Transaction #: 2891617	
Date of Transaction: 06/04/2013	
CUSTOMER:	
DEPARTMENT OF LAND TRANSFER INFORMATION 942 CALLE AMANECER STE B SAN CLEMENTE, CA 92673-6220 US	

LINE #	QTY	DESCRIPTION	REMARKS	UNIT PRICE	TOTAL
1	1.00	LOCATABLE MINERALS / MINING CLAIMS- NOT NEW-UNADJUD, ONE AUTH NO. ONLY / MINING CLAIM MONEY RECEIVED CASES: AMC423066/\$10.00	QCD - 1	- n/a -	10.00
TOTAL:					\$10.00

FAILED

PAYMENT INFORMATION					
1	AMOUNT:	10.00	POSTMARKED:	05/31/2013	
	TYPE:	CHECK	RECEIVED:	06/03/2013	
	CHECK NO:	4832			
	NAME:	DEPARTMENT OF LAND TRANSFER INFORMATION 942 CALLE AMANECER STE B SAN CLEMENTE CA 92673-6220 US			

REMARKS

This receipt was generated by the automated BLM Collections and Billing System and is a paper representation of a portion of the official electronic record contained therein.



DEPARTMENT OF LAND TRANSFER INFORMATION
PROTECTING AMERICA'S RESOURCES

STEVEN L. CYROS
SUPERVISORY FIELD AGENT

942 CALLE AMANEGER
BLDG. B / MS 548
SAN CLEMENTE, CA 92673
TEL (949) 366-9484
FAX (949) 366-9945
SCYROS@DLTL.US.COM
WWW.LANDTRANSFER.US.COM

May 31, 2013

Bureau of Land Management
Arizona State Office
One Central Avenue
Suite 800
Phoenix, AZ 85004-4427

RE: Mining Claim Change of Ownership/Quitclaim Deed to be processed

To Whom It May Concern:

Enclosed, please find a Mining Claim Change of Ownership Request in the form of Legal Quitclaim Deed (Notarized) to be processed.

Also attached you will find my check for payment in the amount of \$10.00 for the processing of this Quitclaim Deed. This has already been recorded at the Maricopa County Arizona Recorders Office as required.

You can either return this to me, and I will distribute it to the respective owner, or you can mail it to the individual whose name and address is indicated on the top of the document – whichever you prefer.

Should you need any additional information, please do not hesitate to call on me.

Warmest Regards,

Steven L. Cyrus

RECEIVED
BLM AZ STATE OFFICE
2013 JUN -3 PM 3:18
PHOENIX, ARIZONA

NOTICE!!

These documents have been scanned!

Do not place un-scanned documents beneath this notice!

Do not remove this notice from this file!

GPO Jacket No. 560-102
Print Order 61540
Rise Business Services, LLC
Job=AZ15 5/13/2019



Box Number= AZ15040



Claim Begin-End: AMC423065-AMC423066

4 Miscellaneous



AZ15040-15

AMC422569-AMC423150

**NO
DOCUMENTS
FOUND**

NO DOCUMENTS FOUND
NO DOCUMENTS FOUND

NOTICE!!

These documents have been scanned!

Do not place un-scanned documents beneath this notice!

Do not remove this notice from this file!

GPO Jacket No. 560-102
Print Order 61540
Rise Business Services, LLC
Job=AZ15 5/13/2019



Box Number= AZ15040



Claim Begin-End: AMC423065-AMC423066

5 Annual Filings



AZ15040-15

AMC422569-AMC423150

DEPARTMENT OF THE INTERIOR
BUREAU OF LAND MANAGEMENT
MINING CLAIMS

Run Date/Time: 9/11/2018

MC Maintenance Fees Paid Through the BLM Pay Portal
(by Date Paid)

Page 218 Of 723

CBS Receipt: 4244212

Printed For Lead File # **AMC423065**

Agency Tracking ID: 1535137770

Assessment Year: 2019

Paid On: 8/24/2018

Number of BLM Serial Nr: 3

Total Amount Paid: \$465.00

Claim Name	BLM Serial No	Lead File No	Amount Paid
BONNIE	AMC423066	AMC423065	\$155.00
BLACK NUGGET	AMC423705	AMC423705	\$155.00
COYOTE WASH GOLD #1	AMC426235	AMC426231	\$155.00

**United States Department of the Interior
Bureau of Land Management
BUSINESS & SUPPORT SVCS DIV
ONE N CENTRAL AVE SUITE 800
PHOENIX, AZ 85004 -4427
Phone: 602-417-9200**

Receipt

No: 4244212

Transaction #: 4359659	
Date of Transaction: 08/24/2018	
CUSTOMER:	
GREGORY WEST 327 E WASHINGTON AVE HOBART,IN 46342 US	

LINE #	QTY	DESCRIPTION	REMARKS	UNIT PRICE	TOTAL
1	1.00	LOCATABLE MINERALS / MINING CLAIMS- NOT NEW-UNADJUD,ONE AUTH NO. ONLY / MINING CLAIM MONEY RECEIVED CASES: AMC423066/\$465.00		- n/a -	465.00
TOTAL:					\$465.00

PAYMENT INFORMATION			
NOTE: Items will appear on credit card statement as "BLM O Mining Claim".			
1	AMOUNT:	465.00	POSTMARKED: N/A
	TYPE:	CREDIT CARD	RECEIVED: 08/24/2018
	NAME:	GREGORY WEST 327 E WASHINGTON AVE HOBART IN 46342 US	
	CARD NO:	XXXXXXXXXXXX1114	AUTH CODE: 615923
	NAME ON CARD:	GREGORY WEST	
	SIGNATURE:		

REMARKS

This receipt was generated by the automated BLM Collections and Billing System and is a paper representation of a portion of the official electronic record contained therein.

Run Date: 09/05/17

Run Time: 02:33 PM

**DEPARTMENT OF THE INTERIOR
BUREAU OF LAND MANAGEMENT
MINING CLAIMS**

MC Maintenance Fees Paid Through the BLM Pay Portal

CBS Receipt: 3963909

Printed For Lead File # AMC423065

Agency Tracking ID: 1503952566

Assessment Year: 2018

Number of BLM Serial Nr: 3

Paid On: 08/28/2017

Total Amount Paid: \$465.00

Claim Name	BLM Serial No	Lead File No	Amount Paid
BONNIE	AMC423066	AMC423065	\$155.00
BLACK NUGGET	AMC423705	AMC423705	\$155.00
COYOTE WASH GOLD #1	AMC426235	AMC426231	\$155.00

United States Department of the Interior
Bureau of Land Management
 BUSINESS & SUPPORT SVCS DIV
 ONE N CENTRAL AVE SUITE 800
 PHOENIX, AZ 85004 -4427
 Phone: 602-417-9200

Receipt

No: 3963909

2

Transaction #: 4073782	
Date of Transaction: 08/28/2017	
CUSTOMER:	
GREGORY A WEST 327 E WASHINGTON AVE HOBART,IN 46342 US	

LINE #	QTY	DESCRIPTION	REMARKS	UNIT PRICE	TOTAL
1	1.00	LOCATABLE MINERALS / MINING CLAIMS- NOT NEW-UNADJUD,ONE AUTH NO. ONLY / MINING CLAIM MONEY RECEIVED CASES: AMC426235/\$465.00		- n/a -	465.00
TOTAL:					\$465.00

PAYMENT INFORMATION			
NOTE: Items will appear on credit card statement as "BLM O Mining Claim".			
1	AMOUNT:	465.00	POSTMARKED: N/A
	TYPE:	CREDIT CARD	RECEIVED: 08/28/2017
	NAME:	GREGORY A WEST 327 E WASHINGTON AVE HOBART IN 46342 US	
	CARD NO:	XXXXXXXXXXXX0196	AUTH CODE: 028503
	NAME ON CARD:	GREGORY A WEST	
	EXPIRES:	12/2019	
	SIGNATURE:		

REMARKS

This receipt was generated by the automated BLM Collections and Billing System and is a paper representation of a portion of the official electronic record contained therein.

UNITED STATES
DEPARTMENT OF THE INTERIOR
BUREAU OF LAND MANAGEMENT

423705
423065
426231

CREDIT CARD PAYMENT
For Mining Claim Maintenance Fee

THIS IS A CHANGE OF ADDRESS

TELEPHONE SUBMISSION - ACCURACY OF THE BELOW INFORMATION IS THE RESPONSIBILITY OF THE CLAIMANT/OWNER

NAME GREGORY WEST
ADDRESS 327 E WASHINGTON AVE
CITY HOBART STATE IN ZIP 46342
PHONE # 219 - 973-1723

SEND RECEIPT TO Above address
 Other (Include Name and Mailing Address):

AMC NUMBER	CLAIM/SITE NAME
<u>423705</u>	<u>BLACK NUGGET</u>
<u>423066</u>	<u>BONNIE</u>
<u>426235</u>	<u>COYOTE WALSH GOLD 1</u>

3 # of Claim/Site
x 155.00 Each
\$ 465 Total Charged YMC (INITIALS)
RECEIPT # 3422320

DATE STAMP

RECEIVED
BLM AZ STATE OFFICE
2016 AUG -5 P 2:11
PHOENIX, ARIZONA
ENTERED
AUG 08 2016
BY: Ran

**** FOR OFFICIAL USE ONLY ****

DATE _____ INITIALS _____ VERIFIED _____

**DEPARTMENT OF THE INTERIOR
 BUREAU OF LAND MANAGEMENT
 MINING CLAIMS
 (MASS) Serial Register Page**

RunDate/Time:08/05/16 02:17 PM

Page: 1 of 3

01 05-10-1872;017STAT0091;30USC26,28,34
Case Type 384101: LODE CLAIM
Commodity:
Claim Name: BONNIE
Case Disposition: ACTIVE
Required Maintenance Fee: \$155.00

Total Acres
20.660

Serial Number
AMC423066
Lead File Number
AMC423065

<u>Name & Address</u>			<u>Int Rel</u>
WEST GREGORY	327 E WASHINGTON AVE	HOBART, IN 46342-1164	CLAIMANT

<u>County/State</u>	<u>District</u>
MOHAVE County, AZ	COLORADO RIVER DO

<u>Mer Twp</u>	<u>Rng</u>	<u>Sec</u>	<u>Subdivision</u>
14	0230N	0180W	001 SW
14	0230N	0180W	012 NW

<u>Act Date</u>	<u>Code</u>	<u>Action Text</u>	<u>Action Remarks</u>	<u>Receipt Number</u>
02/11/2013	403	LOCATION DATE		
05/02/2013	395	RECORDATION NOTICE RECD	1	2787309
08/10/2015	782	MAINTENANCE FEE PAYMENT	2016;\$155	3363630
08/28/2014	782	MAINTENANCE FEE PAYMENT	2015;\$155	3116397
09/03/2013	682	MAINTENANCE FEE/\$140	2014;\$140	2876469
05/02/2013	484	LOCATION YEAR / MAINTENAN	2013;\$140	2787309
07/10/2013	669	LAND STATUS CHECKED		
06/03/2013	396	TRF OF INTEREST FILED	DEPT OF LAND TRANSFER	2806586
05/02/2013	501	ACCT ADV IN LEAD FILE	AMC423065-AMC423066;	

<u>Line Nr</u>	<u>Remarks</u>
----------------	----------------

**DEPARTMENT OF THE INTERIOR
 BUREAU OF LAND MANAGEMENT
 MINING CLAIMS
 (MASS) Serial Register Page**

RunDate/Time:08/05/16 02:17 PM

Page: 2 of 3

01 05-10-1872;017STAT0091;30USC26,28,34
Case Type 384101: LODE CLAIM
Commodity:
Claim Name: BLACK NUGGET
Case Disposition: ACTIVE
Required Maintenance Fee: \$155.00

Total Acres
 20.660

Serial Number
AMC423705
Lead File Number
AMC423705

<u>Name & Address</u>	<u>Int Rel</u>
WEST GREGORY 327 E WASHINGTON AVE HOBART, IN 46342-1164	CLAIMANT

<u>County/State</u>	<u>District</u>
MARICOPA County, AZ	PHOENIX DO

<u>Mer Twp</u>	<u>Rng</u>	<u>Sec</u>	<u>Subdivision</u>
14	0050N	0090W	020 NW,SW

<u>Act Date</u>	<u>Code</u>	<u>Action Text</u>	<u>Action Remarks</u>	<u>Receipt Number</u>
04/19/2013	403	LOCATION DATE		
06/27/2013	395	RECORDATION NOTICE RECD	1	2822036
08/10/2015	782	MAINTENANCE FEE PAYMENT	2016;\$155	3363630
08/28/2014	782	MAINTENANCE FEE PAYMENT	2015;\$155	3116397
09/03/2013	682	MAINTENANCE FEE/\$140	2014;\$140	2876469
06/27/2013	484	LOCATION YEAR / MAINTENAN	2013;\$140	2822036
07/22/2013	669	LAND STATUS CHECKED		
07/15/2013	396	TRF OF INTEREST FILED	DEPT OF LAND TRANSFER	2833198
06/27/2013	501	ACCT ADV IN LEAD FILE	AMC423705-AMC423708	

<u>Line Nr</u>	<u>Remarks</u>
----------------	----------------

**DEPARTMENT OF THE INTERIOR
BUREAU OF LAND MANAGEMENT
MINING CLAIMS
(MASS) Serial Register Page**

RunDate/Time:08/05/16 02:17 PM

Page: 3 of 3

01 10-21-1976;090STAT0090;43USC1744
Case Type 384201: PLACER CLAIM
Commodity:
Claim Name: COYOTE WASH GOLD #1
Case Disposition: ACTIVE
Required Maintenance Fee: \$155.00

Total Acres
20.000

Serial Number
AMC426235
Lead File Number
AMC426231

<u>Name & Address</u>			<u>Int Rel</u>
WEST GREGORY	327 E WASHINGTON AVE	HOBART, IN 46342-1164	CLAIMANT

<u>County/State</u>	<u>District</u>
MARICOPA County, AZ	PHOENIX DO

<u>Mer Twp</u>	<u>Rng</u>	<u>Sec</u>	<u>Subdivision</u>
14	0040N	0060W	018 NW

<u>Act Date</u>	<u>Code</u>	<u>Action Text</u>	<u>Action Remarks</u>	<u>Receipt Number</u>
01/02/2014	403	LOCATION DATE		
01/24/2014	395	RECORDATION NOTICE RECD	1	2955415
08/10/2015	782	MAINTENANCE FEE PAYMENT	2016;\$155	3363630
08/28/2014	782	MAINTENANCE FEE PAYMENT	2015;\$155	3116397
01/24/2014	484	LOCATION YEAR / MAINTENAN	2014;\$140	2955415
06/26/2014	669	LAND STATUS CHECKED		
03/27/2014	396	TRF OF INTEREST FILED	MINEFINDER GOLD	2997708
01/24/2014	501	ACCT ADV IN LEAD FILE	AMC426231-AMC426236;	

<u>Line Nr</u>	<u>Remarks</u>
----------------	----------------

**United States Department of the Interior
Bureau of Land Management
DIV OF LANDS, MINRLS & ENERGY
ONE N CENTRAL AVE
PHOENIX, AZ 85004 -4427
Phone: 602-417-9200**

Receipt

No: 3622320

Transaction #: 3726052	
Date of Transaction: 08/05/2016	
CUSTOMER:	
GREGORY WEST 327 E WASHINGTON AVE HOBART,IN 46342-1164 US	

LINE #	QTY	DESCRIPTION	REMARKS	UNIT PRICE	TOTAL
1	1.00	LOCATABLE MINERALS / MINING CLAIMS- NOT NEW-UNADJUD,ONE AUTH NO. ONLY / MINING CLAIM MONEY RECEIVED CASES: AMC423705/\$465.00	MAINT 2017/3	- n/a -	465.00
TOTAL:					\$465.00

PAYMENT INFORMATION			
NOTE: Items will appear on credit card statement as "Bureau of Land Mgmt CO".			
1	AMOUNT:	465.00	POSTMARKED: N/A
	TYPE:	CREDIT CARD	RECEIVED: 08/05/2016
	NAME:	WEST, GREGORY 327 E WASHINGTON AVE HOBART IN 46342-1164 US	
	CARD NO:	XXXXXXXXXXXX5014	AUTH CODE: 005606
	NAME ON CARD:	GREGORY A WEST	
	EXPIRES:	10/2018	
	SIGNATURE:		

REMARKS

This receipt was generated by the automated BLM Collections and Billing System and is a paper representation of a portion of the official electronic record contained therein.

Run Date: 08/17/15

Run Time: 02:46 PM

**DEPARTMENT OF THE INTERIOR
BUREAU OF LAND MANAGEMENT
MINING CLAIMS**

MC Maintenance Fees Paid Through the BLM Pay Portal

CBS Receipt: 3363630

Printed For Lead File # AMC423065

Agency Tracking ID: 1439242057

Number of BLM Serial Nr: 3

Assessment Year: 2016

Total Amount Paid: \$465.00

Paid On: 08/10/2015

Claim Name	BLM Serial No	Lead File No	Amount Paid
BONNIE	AMC423066	AMC423065	\$155.00
BLACK NUGGET	AMC423705	AMC423705	\$155.00
COYOTE WASH GOLD #1	AMC426235	AMC426231	\$155.00

United States Department of the Interior
Bureau of Land Management
 BUSINESS & SUPPORT SVCS DIV
 ONE N CENTRAL AVE SUITE 800
 PHOENIX, AZ 85004 -4427
 Phone: (602) 417-9200

Receipt

No: 3363630

Transaction #: 3461665	
Date of Transaction: 08/10/2015	
CUSTOMER:	
GREGORY A WEST 327 E WASHINGTON AVE HOBART,IN 46342 US	

LINE #	QTY	DESCRIPTION	REMARKS	UNIT PRICE	TOTAL
1	1.00	LOCATABLE MINERALS / MINING CLAIMS- NOT NEW-UNADJUD,ONE AUTH NO. ONLY / MINING CLAIM MONEY RECEIVED CASES: AMC423066/\$465.00		- n/a -	465.00
TOTAL:					\$465.00

PAYMENT INFORMATION			
NOTE: Items will appear on credit card statement as "BLM O Mining Claim".			
1	AMOUNT:	465.00	POSTMARKED: N/A
	TYPE:	CREDIT CARD	RECEIVED: 08/10/2015
	NAME:	GREGORY A WEST 327 E WASHINGTON AVE HOBART IN 46342 US	
	CARD NO:	XXXXXXXXXXXX2821	AUTH CODE: 010860
	NAME ON CARD:	GREGORY A WEST	
	EXPIRES:	01/2018	
	SIGNATURE:		

REMARKS

This receipt was generated by the automated BLM Collections and Billing System and is a paper representation of a portion of the official electronic record contained therein.

UNITED STATES
DEPARTMENT OF THE INTERIOR
BUREAU OF LAND MANAGEMENT

423065
423705
426231

CREDIT CARD PAYMENT
For Mining Claim Maintenance Fee

THIS IS A CHANGE OF ADDRESS

TELEPHONE SUBMISSION - ACCURACY OF THE BELOW INFORMATION IS THE RESPONSIBILITY OF THE CLAIMANT/OWNER

NAME Gregory WEST
ADDRESS 327 E Washington Ave
CITY Hobart STATE IN ZIP 36342-1164
PHONE # 219 - 252-3595

SEND RECEIPT TO Above address
 Other (Include Name and Mailing Address);

AMC NUMBER
423066
423705
426235

CLAIM/SITE NAME
Bonnie
Black Nugget
Coyote Wash Gold #1

3 # of Claim/Site
x 155.00 Each
\$ 465 Total Charged ERG (INITIALS)

RECEIPT # 3116397

DATE STAMP

RECEIVED
M AZ STATE OFFICE
2014 AUG 28 P 4: 01
PHOENIX, ARIZONA

ENTERED ***** FOR OFFICIAL USE ONLY *****
DATE _____ INITIALS _____ VERIFIED _____
BY: RC

United States Department of the Interior
Bureau of Land Management
 LANDS/RECREATION & PLANNING
 ONE N CENTRAL AVE
 PHOENIX, AZ 85004 -2203
 Phone: 602-417-9200

Receipt

No: 3116397

Transaction #: 3208148	
Date of Transaction: 08/28/2014	
CUSTOMER:	
GREGORY WEST 327 E WASHINGTON AVE HOBART,IN 46342-1164 US	

LINE #	QTY	DESCRIPTION	REMARKS	UNIT PRICE	TOTAL
1	1.00	LOCATABLE MINERALS / MINING CLAIMS- NOT NEW-UNADJUD,ONE AUTH NO. ONLY / MINING CLAIM MONEY RECEIVED CASES: AMC423066/\$465.00	2015 MAINT (3)	- n/a -	465.00
TOTAL:					\$465.00

PAYMENT INFORMATION			
NOTE: Items will appear on credit card statement as "Bureau of Land Mgmt CO".			
1	AMOUNT:	465.00	POSTMARKED: N/A
	TYPE:	CREDIT CARD	RECEIVED: 08/28/2014
	NAME:	WEST, GREGORY 327 E WASHINGTON AVE HOBART IN 46342-1164 US	
	CARD NO:	XXXXXXXXXXXX8956	AUTH CODE: 00385B
	NAME ON CARD:	GREGORY A WEST	
	EXPIRES:	09/2016	
	SIGNATURE:		

REMARKS

This receipt was generated by the automated BLM Collections and Billing System and is a paper representation of a portion of the official electronic record contained therein.

UNITED STATES
DEPARTMENT OF THE INTERIOR
BUREAU OF LAND MANAGEMENT
MAINTENANCE FEE PAYMENT FORM FOR
LODE CLAIMS, MILL SITES, AND TUNNEL SITES

423065
423705

Remitter Name: Gregory A. West
Mailing Address: 327 E. Washington Ave
City, State, Zip: Hobart, IN 46342-1164

Check here if this is a change of address.

RECEIVED
BLM AZ STATE OFFICE
2013 SEP -5 P 3:07
PHOENIX, ARIZONA

FOR COUNTY RECORDER'S USE

No. of claims/sites 2
x \$140 per claim/site
Total due BLM \$ 280.00

- The maintenance fee may be paid by cash, check, money order, Bureau of Land Management (BLM) Declining Deposit Account, or credit card (VISA, American Express, Discover, or MasterCard). Payments must be remitted to the BLM State Office where your claim or site is recorded and received on or before September 1. If the payment is mailed, the envelope must be postmarked by a bona fide delivery service on or before September 1 and received at the proper BLM State Office within 15 calendar days after the due date. Payments may also be made by telephone using a credit card. A complete listing of BLM State Offices with their addresses and phone numbers can be found at <http://www.blm.gov>.
- The maintenance fee for the following claim(s)/site(s) applies to the assessment year 2013.

CLAIM/SITE NAME	BLM SERIAL NO.
Chloride, Mohave Co., AZ. Bonnie	AMC 423066
Aguila, Maricopa Co., AZ. ^{Black} Nugget	AMC 423705

Use a separate sheet for additional claim/site names, serial numbers, and claimant names and addresses.

(Continued on page 2)

ENTERED
SEP 11 2013
BY: RE

Receipt # 2876469
ADL

2000912
2075024

INSTRUCTIONS

1. This is an optional form that may be used to satisfy the requirements for the Bureau of Land Management (BLM) under the provisions of 43 U.S.C. §1744 and 30 U.S.C. §28f and the regulations thereunder (43 CFR part 3834). Since local and State laws may vary, you should contact your local and State agencies where the claims are located to ensure all applicable laws and requirements are satisfied.
2. This form should be used to pay the maintenance fee for lode mining claims, mill sites, and tunnel sites only. To pay the maintenance fee for placer mining claims, use Form 3830-5a.
3. Complete the section for the number of claims and the amount being remitted to the BLM.
4. Enter the year in paragraph 2 for the applicable assessment year.
5. List all mining claim or site names and the BLM serial number associated to the claim or site, if the BLM has notified you what the serial number is. Every attempt should be made to include the current BLM serial number for each claim or site listed.
6. The name and current mailing addresses of the person paying the maintenance fee(s) should be listed at the top of the form. If this is a change of address for a claimant, that should also be noted.
7. If needed, an additional sheet can be used to continue listing claim and site names and BLM serial numbers, or the name and current mailing address of additional claimants.
8. If paying by credit card, you must complete the following credit card information on page 3: (a) exact name on the face of the credit card; (b) amount paid; (c) type of card; (d) credit card number; (e) expiration date of the card; and (f) telephone number. You must also sign on page 3 to show authorization to charge the credit card.

RECEIVED
BLM AZ STATE OFFICE
2013 SEP 15 PD 3:07
PHOENIX ARIZONA

NOTICES

THE PRIVACY ACT and 43 CFR 2.48(d) require that you be furnished with the following information in connection with the information requested by this form.

AUTHORITY: 30 U.S.C. 28f and 43 CFR part 3834 permit collection of the information requested by this form.

PRINCIPAL PURPOSE: The BLM will use the information you provide to record the annual maintenance fee payment for the claims and sites listed and to verify that payment has been made in accordance with 30 U.S.C. 28f and 43 CFR part 3834.

ROUTINE USES: The BLM will only disclose this information in accordance with the provisions at 43 CFR 2.56(b) and (c).

EFFECT OF NOT PROVIDING INFORMATION: Disclosure of the requested information is required by 30 U.S.C. 28f and 43 CFR part 3834 for claimants paying the annual maintenance fee. The use of this specific form when paying the maintenance fee is optional. However, when paying the maintenance fee, it is the requested information on this form that is required to be submitted along with the fee. Failure to submit all the required information will delay the BLM's processing of the information and may preclude the BLM's acceptance of the maintenance fee payment, which may result in forfeiture of the mining claim(s) or site(s) by the claimant.

Gregory West
327 E. Washington Ave
Hobart, IN
46342-1164

SANTA ANA CA 926
03 SEP 2013 PM 11 L

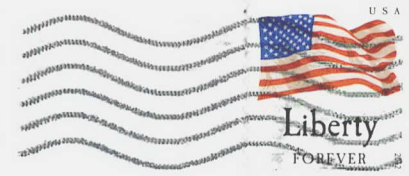

Arizona State Office
One North Central Avenue
Suite 800

Phoenix, AZ 85004-4427
85004442700

RECEIVED
BLM AZ STATE OFFICE
2013 SEP -5 P 3:01
PHOENIX, ARIZONA



Gregory West
327 E. Washington Ave
Hobart, IN
46342-1164

SANTA ANA CA 926

03 SEP 2013 PN 11 L



Arizona State Office
One North Central Avenue
Suite 800

Phoenix, AZ

85004442700

85004-4427

PHOENIX, ARIZONA

2013 SEP - 5 P 3:07

RECEIVED
BLM AZ STATE OFFICE



Gregory West
327 E. Washington Ave
Hobart, IN
46342-1164

SANTA ANA CA 926

03 SEP 2013 PM 11 L



Arizona State Office
One North Central Avenue
Suite 800
Phoenix, AZ 85004-4427

PHOENIX, ARIZONA

2013 SEP -5 P 3:01

RECEIVED
BLM AZ STATE OFFICE

85004442700



**United States Department of the Interior
Bureau of Land Management**

Receipt

LANDS/RECREATION & PLANNING

ONE N CENTRAL AVE

PHOENIX, AZ 85004 -2203

Phone: 602-417-9200

No:

2876469

Transaction #: 2962541	
Date of Transaction: 09/06/2013	
CUSTOMER:	
GREGORY WEST 327 E WASHINGTON AVE HOBART,IN 46342-1164 US	



LINE #	QTY	DESCRIPTION	REMARKS	UNIT PRICE	TOTAL
1	1.00	LOCATABLE MINERALS / MINING CLAIMS- NOT NEW-UNADJUD,ONE AUTH NO. ONLY / MINING CLAIM MONEY RECEIVED CASES: AMC423066/\$280.00	MAINT FEE PYMNT (2) 2014	- n/a -	280.00
TOTAL:					\$280.00

PAYMENT INFORMATION			
NOTE: Items will appear on credit card statement as "Bureau of Land Mgmt CO".			
1	AMOUNT:	280.00	POSTMARKED: N/A 9/3/13
	TYPE:	CREDIT CARD	RECEIVED: 09/05/2013
	NAME:	WEST, GREGORY 327 E WASHINGTON AVE HOBART IN 46342-1164 US	
	CARD NO:	XXXXXXXXXXXX7846	AUTH CODE: 025144
	NAME ON CARD:	GREGORY A WEST	
	EXPIRES:	07/2015	
	SIGNATURE:		

REMARKS

This receipt was generated by the automated BLM Collections and Billing System and is a paper representation of a portion of the official electronic record contained therein.

NOTICE!!

These documents have been scanned!

Do not place un-scanned documents beneath this notice!

Do not remove this notice from this file!

GPO Jacket No. 560-102
Print Order 61540
Rise Business Services, LLC
Job=AZ15 5/13/2019



Box Number= AZ15040



Claim Begin-End: AMC423065-AMC423066

6 Location Notices-Amendments and Supporting Documents



AZ15040-15

AMC422569-AMC423150

**DEPARTMENT OF THE INTERIOR
BUREAU OF LAND MANAGEMENT
MINING CLAIMS
(LIVE) Serial Register Page**

Run Date/Time: 06/14/2013 03:43 PM

Page 1 of 1

01 05-10-1872;017STAT0091;30USC26,28,34	Total Acres	Serial Number
Case Type 384101: LODE CLAIM	20.660	AMC423065
Claim Name: BIG STING		Lead File Number
Commodity :		AMC423065
Case Disposition: ACTIVE		
Required Maintenance Fee: \$140.00		

Name & Address	Int Rel
DEPT OF LAND TRANSFER INFO INC 942 CALLE AMANECER STE B SAN CLEMENTE, CA 92673-6220	CLAIMANT

Mer Twp	Rng	Sec	Quadrant	District/Field Office	County
14	0230N	0180W	001 SW	KINGMAN FO	MOHAVE
14	0230N	0180W	012 NW	KINGMAN FO	MOHAVE

Act Date	Code	Action	Action Remarks	Receipt Number
02/11/2013	403	LOCATION DATE		
05/02/2013	395	RECORDATION NOTICE RECD	1	2787309
05/02/2013	484	LOCATION YEAR / MAINTENANCE	2013;\$140	2787309
05/02/2013	501	ACCT ADV IN LEAD FILE	AMC423065-AMC423066;	

Line Nr Remarks

**DEPARTMENT OF THE INTERIOR
BUREAU OF LAND MANAGEMENT
MINING CLAIMS
(LIVE) Serial Register Page**

Run Date/Time: 06/14/2013 03:43 PM

Page 1 of 1

01 05-10-1872;017STAT0091;30USC26,28,34
Case Type 384101: LODE CLAIM
Claim Name: BONNIE
Commodity :
Case Disposition: ACTIVE
Required Maintenance Fee: \$140.00

Total Acres
20.660

Serial Number
AMC423066
Lead File Number
AMC423065

Name & Address	Int Rel
DEPT OF LAND TRANSFER INFO INC 942 CALLE AMANECER STE B SAN CLEMENTE, CA 92673-6220	CLAIMANT

Mer Twp	Rng	Sec	Quadrant	District/Field Office	County	
14	0230N	0180W	001	SW	KINGMAN FO	MOHAVE
14	0230N	0180W	012	NW	KINGMAN FO	MOHAVE

Act Date	Code	Action	Action Remarks	Receipt Number
02/11/2013	403	LOCATION DATE		
05/02/2013	395	RECORDATION NOTICE RECD	1	2787309
05/02/2013	484	LOCATION YEAR / MAINTENANCE	2013;\$140	2787309
06/03/2013	392	MONIES RECEIVED	\$10.00;1	2806586
05/02/2013	501	ACCT ADV IN LEAD FILE	AMC423065-AMC423066;	

Line Nr Remarks

MINING CLAIM STATUS REPORT

DATA ENTERED JUN 14 2013 PB

MTP Checked by JUN 14 2013 PB
GEO Checked by JUN 14 2013 PB

LEAD SERIAL NUMBER AMC 423065 thru AMC 423066

OF CLAIMS & TYPE

2 LODE
_____ PLACER
_____ ASSOCIATION PLACER
_____ MILL SITE
_____ TUNNEL SITE

CHARGES

Location Fee @ \$34 = \$ 68.00
Processing Fee @ \$15 = \$ 30.00
Maintenance Fee @ \$140 = \$ 280.00
Overage (+) \$ _____
Shortage (-) \$ _____
Other Fees \$ _____
TOTAL \$ 378.00

TOTAL CLAIM ACREAGE? _____

OF LOCATORS? _____

DOCUMENTS RECEIVED VIA -

Over-the-Counter [] Mail [X]

TIMELY FILED?

Yes [X] No []

LEGAL DESCRIPTION - T 23N R 18W SEC 12, 1
T _____ R _____ SEC _____
T _____ R _____ SEC _____
T _____ R _____ SEC _____

BLM [] FOREST SERVICE [] SUBJ TO PL 359: Yes [] No []

WILDERNESS AREA: No [] Yes []

SPLIT ESTATE - N/A [] SX [] PX [] SRHA [] OTHER []

Proper Notice Filed if Located on SHRA Lands? N/A [] Yes [] No []

RECONVEYED MINERALS ON BLM LANDS REQUIRE OPENING ORDERS FROM 1944 TO 1993 -

Open to Entry on: _____ N/A []

COMMENTS/STATUS - VOID [] PARTIALLY VOID [] PVT MINERALS [] WITHDRAWN LANDS []

OTHER [] _____

Claimant acknowledges that portions of the following claims(s) site(s) may be void or voidable.

Printed Name of Claimant _____ Signature of Claimant _____

***** FINAL ADJUDICATION *****

DATE 7/10/13 INITIALS AT

AMC 423065

RECORDING REQUESTED BY:

(Mail recording to;)

Department of Land

Transfer Information, Inc.

942 Calle Amanecer, Suite B

San Clemente, CA 92673

FOR RECORDER'S USE

LOCATION NOTICE FOR LODE MINING CLAIM

NOTICE IS HEREBY GIVEN that the **BIG STING** lode mining claim has been located by Department of Land Transfer Information, Inc., a Wyoming Corporation whose current mailing address is 942 Calle Amanecer, Suite B, San Clemente, CA 92673.

The general course of this claim is North and South and it is situated in the Gila Salt River Meridian, Mohave County, Arizona.

This claim is 1,500 feet in length and 600 feet in width. This claim runs from the location monument on which this location notice is posted approximately 1,200 feet in a Northerly direction to the North end line and approximately 300 feet in a Southerly direction to the South end line.

This claim is marked by four (4) monuments, one at each corner of the claim. Additionally, there are two (2) end-line markers on each side of the center of the claim. All markers are 4" x 4" wooden posts that are buried 1.5' in the ground and protrude 4.5' above the ground embossed with the name of the claim and its location in relation to the claim.

The location monument on which this notice is posted is situated within Section 12, Township 23N, Range 18W, Gila Salt River Meridian, Mohave County Arizona and this claim encompasses portions of the following quarter section (s), Township (s) and Range (s); SW 1/4 of SW 1/4 of Section 1 and NW 1/4 of NW 1/4 Section 12, T23N, R18W, Gila Salt River Meridian, Mohave County Arizona.

The locality of this claim with reference to some natural object or permanent monument and additional information (if any) concerning its locality are as follows: NW corner of this claim is 660 Feet East and 700 Feet North of the NW corner of Section 12, T23N, R18W Gila Salt River Meridian, Mohave County AZ.

DATED AND POSTED on the ground this 11th day of February, 2013.

Locator of this lode mining claim is:

DEPARTMENT OF LAND TRANSFER INFORMATION, INC.

Steven L. Cyros, President

Authorized Officer for DEPARTMENT OF LAND TRANSFER INFORMATION, INC.

BLM Date Stamp	PHOENIX, ARIZONA	2013 MAY -2 P 12 1	RECEIVED BLM AZ STATE OFFICE
----------------------	------------------	--------------------	---------------------------------

110423065

MINING CLAIM MAP

- 1) Name of Claim; **BIG STING**
- 2) Type of Claim; **LODE**
- 3) Location Monument is located in Section 12, Township 23N, Range 18W, Gila-Salt River Meridian, Mohave County, Arizona.
- 4) The types of corner and location monuments used are as follows: 4" X 4" Wooden Posts.

Lode Mining Claim The Sting, Chloride Mining District, Mohave County, Arizona

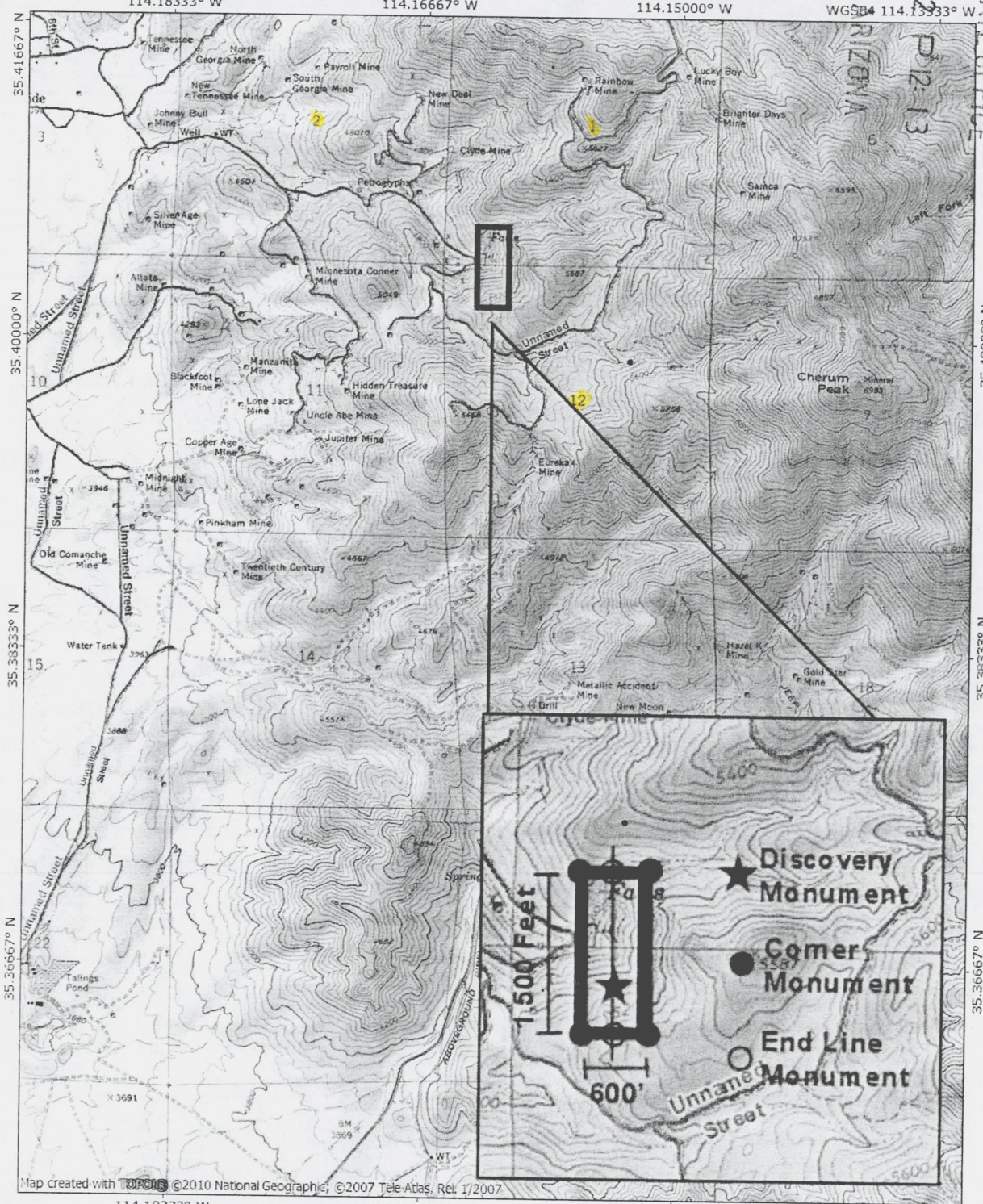

Map created with TOPOGIS ©2010 National Geographic; ©2007 Tele-Atlas, Rel. 1/2007

NATIONAL GEOGRAPHIC

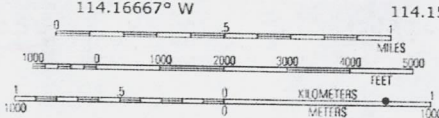

RECEIVED
MAY 2013
2 P 12:13
MAY 2013
STATE OFFICE

AN0423065

TN MN
11 1/2°
04/30/13

RECORDING REQUESTED BY:

(Mail recording to;)

Department of Land

Transfer Information, Inc.

942 Calle Amanecer, Suite B

San Clemente, CA 92673

FOR RECORDER'S USE

LOCATION NOTICE FOR LODE MINING CLAIM

NOTICE IS HEREBY GIVEN that the **BONNIE** lode mining claim has been located by Department of Land Transfer Information, Inc., a Wyoming Corporation whose current mailing address is 942 Calle Amanecer, Suite B, San Clemente, CA 92673.

The general course of this claim is North and South and it is situated in the Gila Salt River Meridian, Mohave County, Arizona.

This claim is 1,500 feet in length and 600 feet in width. This claim runs from the location monument on which this location notice is posted approximately 1,200 feet in a Northerly direction to the North end line and approximately 300 feet in a Southerly direction to the South end line.

This claim is marked by four (4) monuments, one at each corner of the claim. Additionally, there are two (2) end-line markers on each side of the center of the claim. All markers are 4" x 4" wooden posts that are buried 1.5' in the ground and protrude 4.5' above the ground embossed with the name of the claim and its location in relation to the claim.

The location monument on which this notice is posted is situated within Section 12, Township 23N, Range 18W, Gila Salt River Meridian, Mohave County Arizona and this claim encompasses portions of the following quarter section (s), Township (s) and Range (s); SW 1/4 of SW 1/4 of Section 1, NW 1/4 of NW 1/4 of Section 12, T23N, R18W, Gila Salt River Meridian, Mohave County Arizona.

The locality of this claim with reference to some natural object or permanent monument and additional information (if any) concerning its locality are as follows: NW corner of this claim is 0 Feet East and 500 Feet North of the NW corner of Section 12, T23N, R18W, Gila Salt River Meridian, Mohave County AZ.

DATED AND POSTED on the ground this 11th day of February, 2013.

Locator of this lode mining claim is:

DEPARTMENT OF LAND TRANSFER INFORMATION, INC.



Steven L. Cyros, President

Authorized Officer for DEPARTMENT OF LAND TRANSFER INFORMATION, INC.

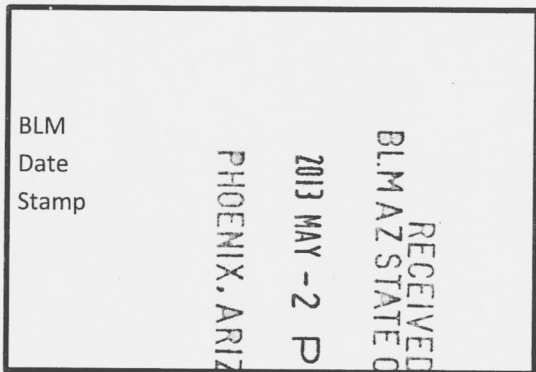

ATTN: 23066

MINING CLAIM MAP

- 1) Name of Claim; **BONNIE**
- 2) Type if Claim; **LODE**
- 3) Location Monument is located in Section 12, Township 23N, Range 18W, Gila-Salt River Meridian, Mohave County, Arizona.
- 4) The types of corner and location monuments used are as follows: 4" X 4" Wooden Post

Lode Mining Claim Bonnie, Chloride Mining District, Mohave County, Arizona
 114.18333° W 114.16667° W WGS84 114.15000° W

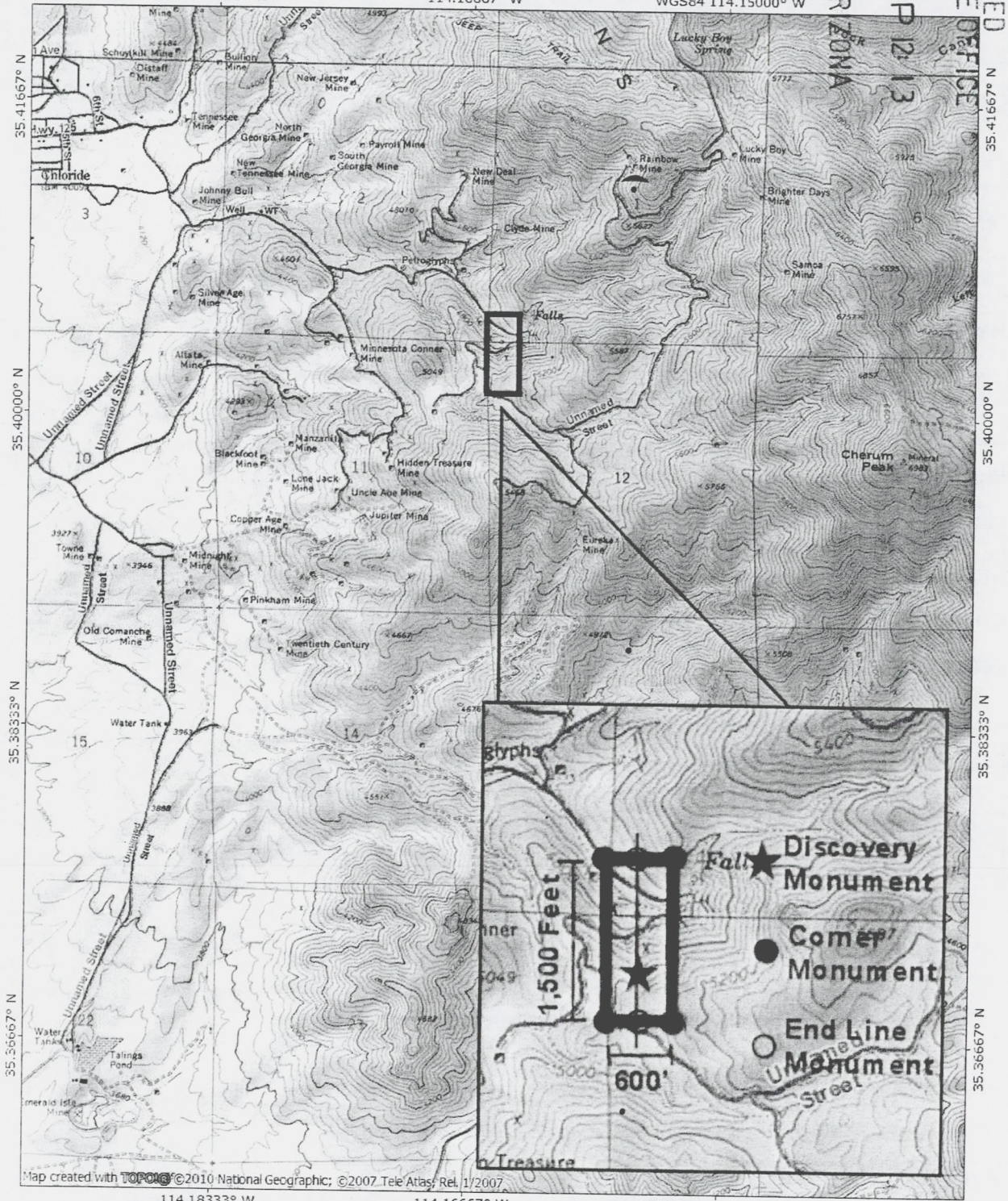

Map created with **TOPON** ©2010 National Geographic; ©2007 Tele Atlas; Rel. 1/2007

NATIONAL GEOGRAPHIC

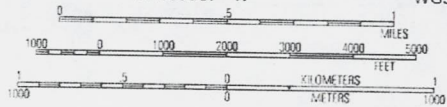

TN* MN
 11 1/2°
 04/30/13

RECEIVED
 BLAIZ STATE OFFICE
 2013 MAY -2 P 12 13
 PHOENIX, ARIZONA

A110423066



DEPARTMENT OF LAND TRANSFER INFORMATION
PROTECTING AMERICA'S RESOURCES

STEVEN L. CYROS
SUPERVISORY FIELD AGENT

942 CALLE AMANECER
BLDG. B / MS 548
SAN CLEMENTE, CA 92673
TEL (949) 366-9484
FAX (949) 366-9945
SCYROS@DLTI.US.COM
WWW.LANDTRANSFER.US.COM

May 1, 2013

Bureau of Land Management
Arizona State Office
One Central Avenue
Suite 800
Phoenix, AZ 85004-4427

RE: Location Notices/Filings for Mining Claim and payment on the following new placer Mining Claims;

1. BONNIE Lode Mining Claim
2. BIG STING Lode Mining Claim

To Whom It May Concern:

Enclosed, please find my check payable to Department of the Interior/BLM for payment in the amount of \$378.00 for the processing of the following two (2) location notices/lode mining claims (2 claims X \$189.00/Each), as well as the signed location notices dated on February 11th of 2013 and a copy of the respective location maps.

Should you need any additional information, please do not hesitate to call on me.

Warmest Regards,

Steven L. Cyros, President

RECEIVED
BLM AZ STATE OFFICE
2013 MAY -2 P 12: 12
PHOENIX, ARIZONA

AMC 423065

express®
by Air®

Visit **ups.com**® or call **1-800-PICK-UPS**® (1-800-742-5877) to schedule a pickup or find a drop off location near you.

Domestic Shipments

- To qualify for the Letter rate, UPS Express Envelopes may only contain correspondence, urgent documents, and/or electronic media, and must weigh 8 oz. or less. UPS Express Envelopes containing items other than those listed or weighing more than 8 oz. will be billed by weight.

International Shipments

- The UPS Express Envelope may be used only for documents of no commercial value. Certain countries consider electronic media as documents. Visit ups.com/importexport to verify if your shipment is classified as a document.
- To qualify for the Letter rate, the UPS Express Envelope must weigh 8 oz. or less. UPS Express Envelopes weighing more than 8 oz. will be billed by weight.

Note: Express Envelopes are not recommended for shipments of electronic media containing sensitive personal information or breakable items. Do not send cash or cash equivalent.

Apply shipping documents on this side.

Do not use this envelope for:

STEVEN CYROS
(949) 366-9484
FTF TECHNOLOGIES, INC.
942 CALLE AMANECER, SUITE B
SAN CLEMENTE CA 92673-6220

LTR 1 OF 1

SHIP TO:
BUREAU OF LAND MANAGEMENT
(602) 417-9200
ARIZONA STATE OFFICE
SUITE 800
ONE NORTH CENTRAL AVENUE
PHOENIX AZ 85004-4427

Expedit[®]
Expedited[®]

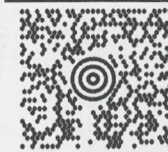

AZ 850 9-10



UPS NEXT DAY AIR SAVER 1P

TRACKING #: 1Z 614 Y2R 13 6954 7014

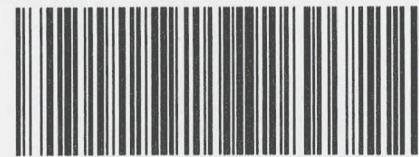

BILLING: P/P

HS 16.0.31

39.0A 04/2013



SEE NOTICE ON REVERSE regarding UPS terms, and notice of limitation of liability. Where allowed by law, shippers authorize UPS to act as forwarding agent for export control and custom purposes. If required from the U.S. shippers certify that the commodities, technology or software were reported from the U.S. in accordance with the Export Administration Regulations. Diversion contrary to law is prohibited.

100% Recycled fiber
80% Post-Consumer



International Shipping Notice — Carriage hereunder may be subject to the rules relating to liability and other terms and/or conditions established by the Convention for the Unification of Certain Rules Relating to International Carriage by Air (the "Warsaw Convention") and/or the Convention on the Contract for the International Carriage of Goods by Road (the "CMR Convention"). These commodities, technology or software were exported from the U.S. in accordance with the Export Administration Regulations. Diversion contrary to U.S. law prohibited.

010195101 1/10 1P United Parcel Service, Louisville, KY

Express Envelope

RECEIVED
BLMAZ STATE OFFICE

2013 MAY -2 P 12: 12

PHOENIX, ARIZONA

Synchronizing the world of commerce™



ARIZONA STATE OFFICE
1 N CENTRAL AVE
STE 800
PHOENIX AZ 85004-4414
P: PURPLE S: ORANGE I: 43D
0905-4000
12614Y2R136954 7014
SAT09485 MAY 02 05:04:13 2013
US 0501 NIPPS 12.1.6 SAT09485sL
1500

DEPARTMENT OF INTERIOR
BUREAU OF LAND MANAGEMENT

Input Parameters for Geographic Report with Land

System Id = CR

Admin State = AZ

Geo State = AZ

Casetype Begins With

Case Disp Txt = AUTHORIZED, CANCELLED, EXPIRED, PENDING, REJECTED, RELINQUISHED, WITHDRAWN

Mer Twp Rng = 14 0230N 0180W

Section = 001, 012, 999

Mtrs =

Commodity =

Commodity Txt =

Pending Org =

Pend Org Decode =

Total Rows Returned: 9

RUN TIME: 03:45 PM

Adm State: AZ

UNITED STATES DEPARTMENT OF INTERIOR
BUREAU OF LAND MANAGEMENT
GEOGRAPHIC REPORT WITH LAND
Sorted by Meridian Township Range

RUN DATE: 06/14/2013

Page 1 of 2

Serial Number: AZA 007017
Total Case Acres: 378.790

<u>Casetype</u>	<u>Case Disp</u>				<u>Sect</u>	<u>Sur Typ</u>	<u>Sur Num</u>	<u>Suff</u>	<u>Subdivision</u>	<u>Act Pend</u>
281008	AUTHORIZED	14	0230N	0180W	001	LOTS			17,25;	

Serial Number: AZA 019995
Total Case Acres: 4.876

<u>Casetype</u>	<u>Case Disp</u>				<u>Sect</u>	<u>Sur Typ</u>	<u>Sur Num</u>	<u>Suff</u>	<u>Subdivision</u>	<u>Act Pend</u>
285003	AUTHORIZED	14	0230N	0180W	001	LOTS			19;	

Serial Number: AZA 028681
Total Case Acres: 5.210

<u>Casetype</u>	<u>Case Disp</u>				<u>Sect</u>	<u>Sur Typ</u>	<u>Sur Num</u>	<u>Suff</u>	<u>Subdivision</u>	<u>Act Pend</u>
286001	AUTHORIZED	14	0230N	0180W	001	MNR		1	SWSWSW;	
					012	LOTS			1;	
						MNR		1	W2NWNW,NESWNW,E2SEW;	
						MNR		2	N2N2SW;	

Serial Number: AZA 031001
Total Case Acres: 0.002

<u>Casetype</u>	<u>Case Disp</u>				<u>Sect</u>	<u>Sur Typ</u>	<u>Sur Num</u>	<u>Suff</u>	<u>Subdivision</u>	<u>Act Pend</u>
289001	AUTHORIZED	14	0230N	0180W	012	MNR			SWNENW;	

RUN TIME: 03:45 PM

Adm State: AZ

UNITED STATES DEPARTMENT OF INTERIOR
BUREAU OF LAND MANAGEMENT
GEOGRAPHIC REPORT WITH LAND
Sorted by Meridian Township Range

RUN DATE: 06/14/2013
Page 2 of 2

Serial Number: AZPHX 0034352

Total Case Acres: 424.177

<u>Casetype</u>	<u>Case Disp</u>				<u>Sect</u>	<u>Sur Typ</u>	<u>Sur Num</u>	<u>Suff</u>	<u>Subdivision</u>	<u>Act Pend</u>
285003	AUTHORIZED	14	0230N	0180W	001	ALIQ LOTS			S2SW,SWSE; 31;	

TOWNSHIP 23 NORTH RANGE 18 WEST OF THE GILA AND SALT RIVER MERIDIAN, ARIZONA

MOHAVE COUNTY

STATUS OF PUBLIC DOMAIN
LAND AND MINERAL TITLES

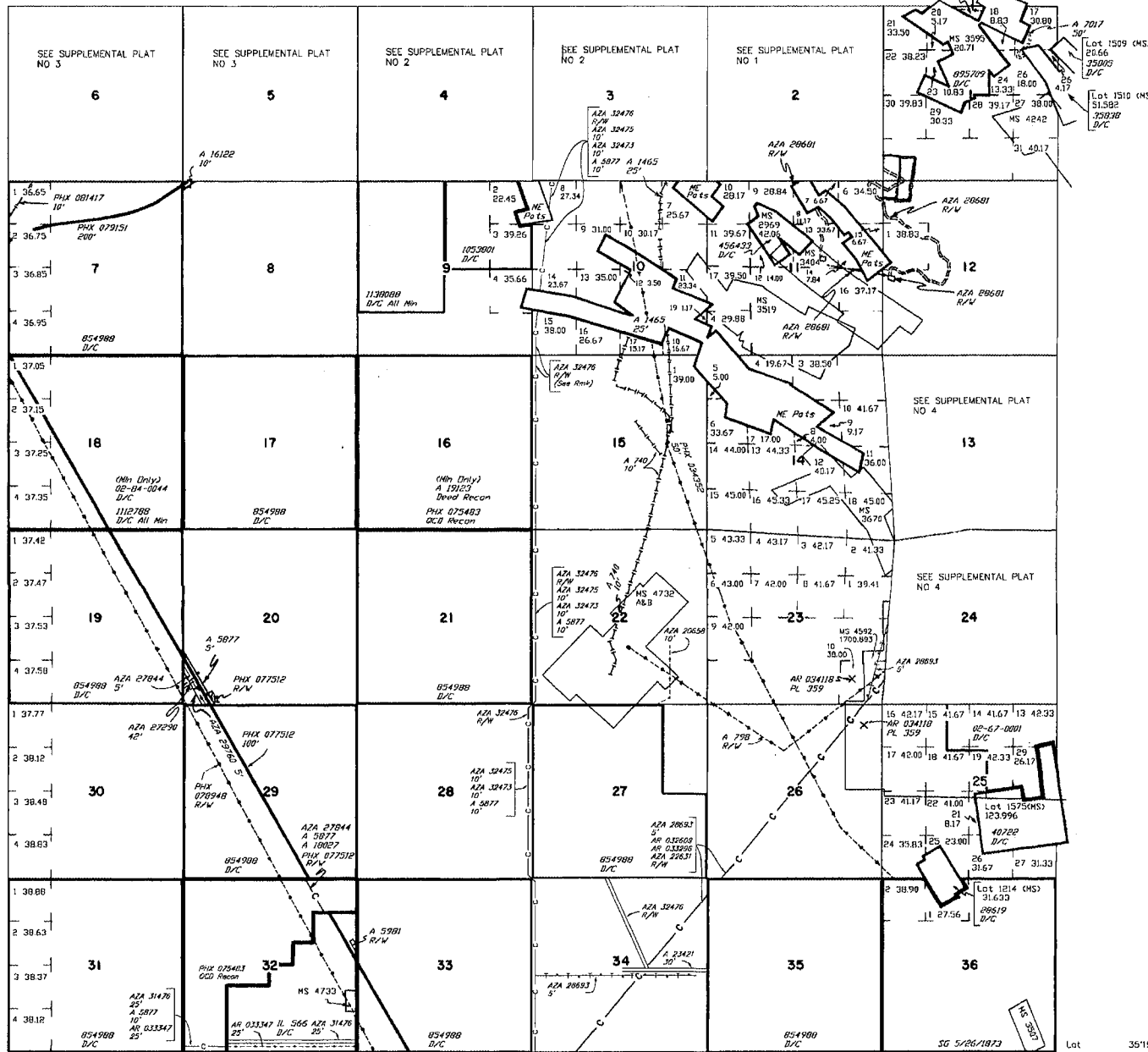

INDEX TO SEGREGATED TRACTS				
SURVEY	ORIGINAL SURVEY			
	TRACT NO	T	R	SUBDIVISION

FOR ORDERS AFFECTING DISPOSAL OR USE OF UNIDENTIFIED LANDS WITHDRAWN FOR CLASSIFICATION, MINERALS, WATER AND/OR OTHER PUBLIC PURPOSES, REFER TO INDEX OF MISCELLANEOUS DOCUMENTS.

DIST NO 2

GRAZING DIST NO 2

- MDS 451 NE
- 452 NW
- 453 SW
- 454 SE

AZA 26521 R/W

- Sec 20 : W1/2SW1/4
- Sec 32 : N1/2NE1/4

AZA 27301 R/W

Sec 20 : NW1/4 M&B

AZA 30121 R/W 10'

Sec 22 : NW1/4SW1/4, SW1/4SW1/4SW1/4SW1/4

AR 033343 R/W 25'

Sec 24 : Lot 7

AZA 32478 R/W

- Sec 9 : E1/2SE1/4SE1/4
- Sec 16 : E1/2E1/2E1/2E1/2E1/2

Lat 35°19'45"N
Long 114°08'56"W

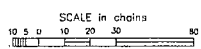

WARNING STATEMENT
This plat is the Bureau's Record of Title, and should be used only as a graphic display of the Bureau's survey data. Records hereon do not reflect title changes which may have been effected by lateral movements of rivers or other bodies of water. Refer to the Colorado survey for official survey information.

CURRENT TO	GS	CSR Mer
7-21-2005	PV	T 23 N R 18 W